



Apt 401 Ryedale House Piccadilly YO1 9NX

£2,500 Per Month

2



2



1



C



A fine example of city centre apartment living, offering spectacular views over the River Foss, Clifford's Tower and York Minster. Ryedale House is an exclusive, private development in the heart of the city centre with impressive lobby warded by an on site concierge and secure allocated parking. The fourth floor apartment is finished to a high standard and offered on a furnished basis. Arrive into the apartment's entrance hallway, leading to an open plan living kitchen space with dual aspect, floor to ceiling windows and a sliding door with Juliette balcony offering impressive panoramic views over some of York's best landmarks. The contemporary kitchen is well considered, equipped with integrated fridge freezer, oven, hob and dishwasher. The washing machine is stowed in a utility cupboard off the entrance hallway. The primary bedroom benefits from both super king sized bed and an en-suite bathroom with overhead shower. The second double bedroom has an en-suite shower room. Additional WC off the entrance hallway. Underfloor heating has been installed throughout the apartment.

Available January 2025 / 6+ Month Tenancy / Deposit £2600 / Council Tax Band E / EPC Rating C

One Allocated Parking Space



Kitchen/Living/Dining Room 6170mm x 6165mm 20'3" x 20'3"
Bedroom 1 5920mm x 3020mm 19'5" x 9'11"
Bedroom 2 4610mm x 3579mm 15'1" x 11'8"

■ Column

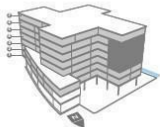

Apartments
Floor 3: 3.1 Floor 5: 5.1
Floor 4: 4.1 Floor 6: 6.1



Ashtons Lettings

01904 731404

lettings@ashtonsnet.com